



PRO lift

FITTING INSTRUCTION

Mitsubishi L200

In case of required
assistance call us under:
+49 (0)341-49 579 232.

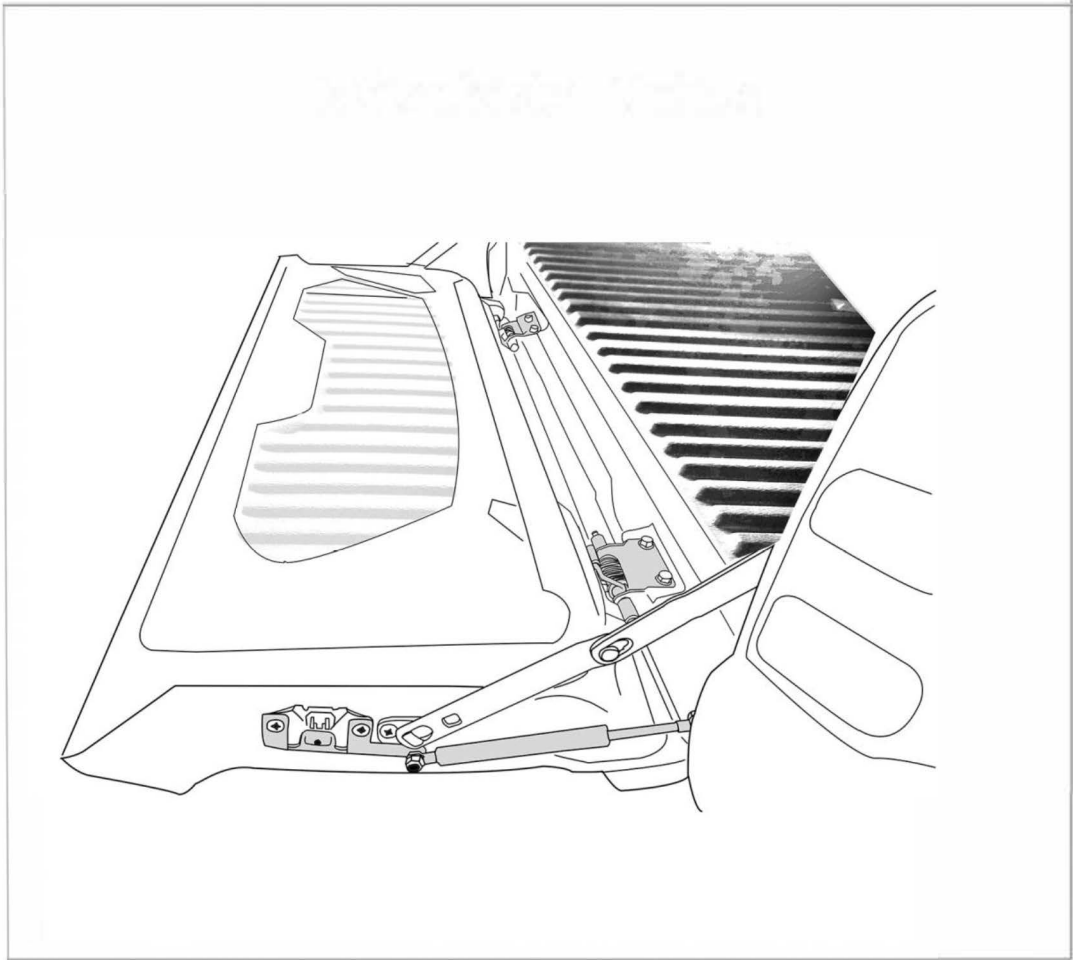

Patent Pending Worldwide

Part list

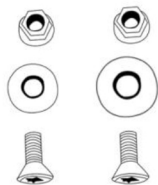

Tooling



No.14



No.10



No.14

No.12

1. Take off original tailgate bracket

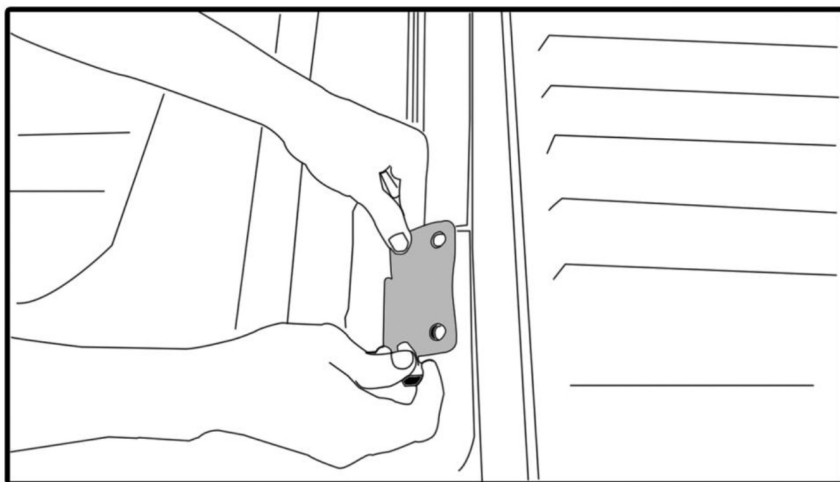

2. Put ProLift brackets with the tailgate using original bolts

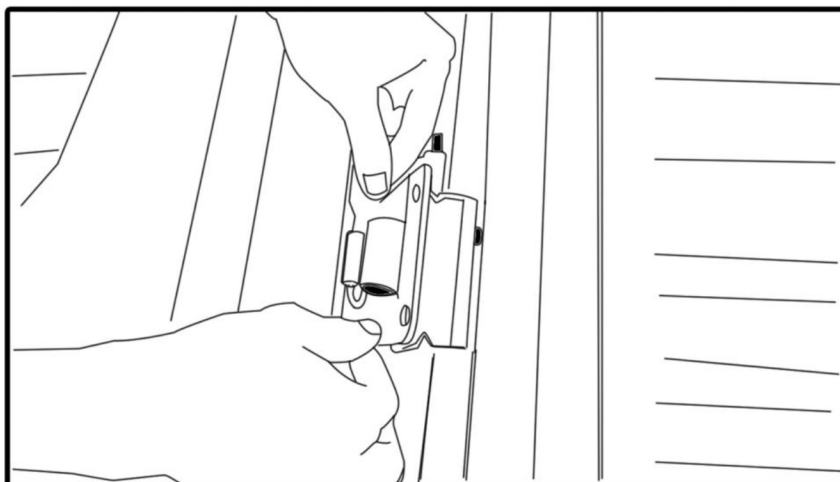

- 3. Lift the tailgate to proper position
and fit the ProLift bracket with
the truck using original bolts**

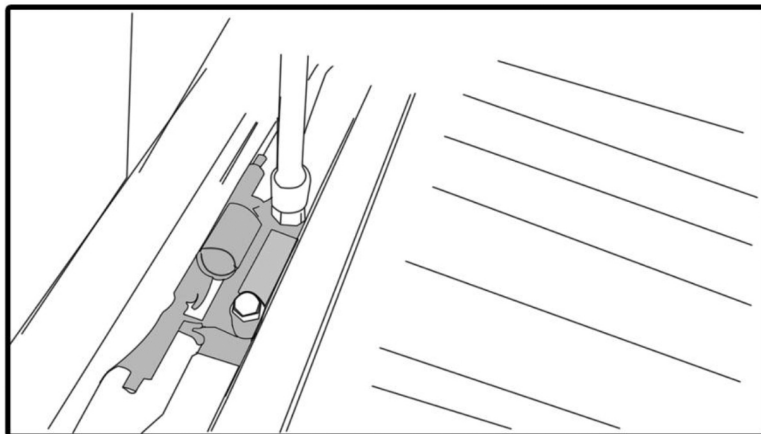

- 4. Open the tailgate and take out the
stopper rubber**

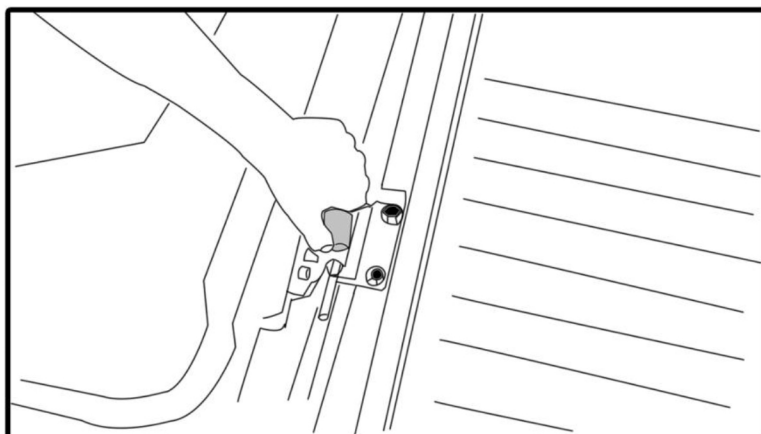

5. Un bolt A&B to take out rear light.
take out rubber (C)

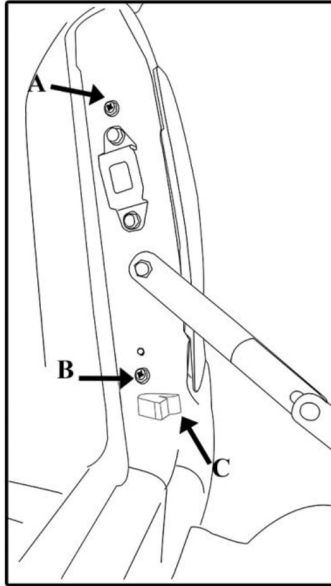

Caution!
Take out rear light
in the correct direction
(Backward)

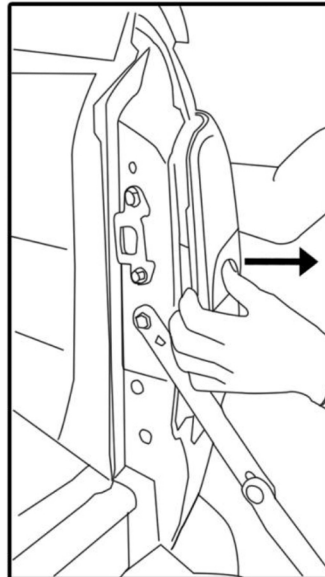

6. Attach damper bracket with the truck using M8 bolts and nut(D)(E). Then put back the rear light.

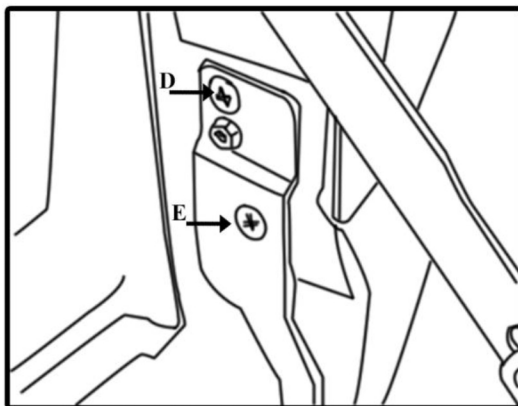

7. Attach damper bracket to the tailgate using original bolts.

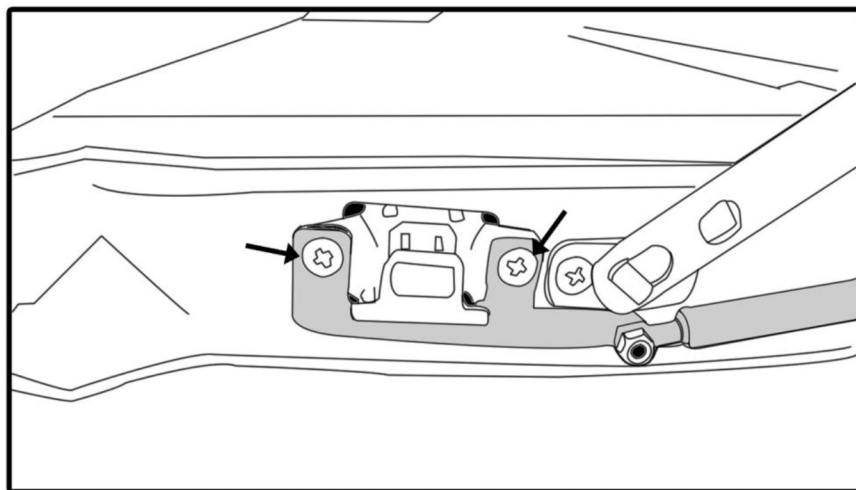

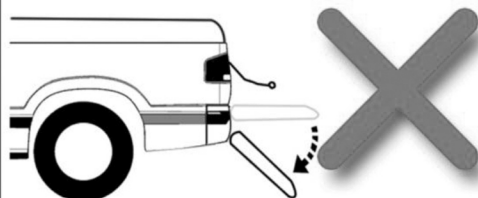
CAUTION

Do not take off
tailgate cable
and drop down
the tailgate

Note :

Apply WD40 or grease to the moving parts regularly for good performance of the product.

Patent Pending Worldwide